



The logo for Vista Shaw features a stylized 'V' composed of three overlapping shapes: a dark blue one on the left, a green one in the middle, and a lighter green one on the right. To the right of the 'V' is the word 'VISTA' in a dark blue, sans-serif font. Below 'VISTA' is a thin horizontal line, and underneath that is the word 'SHAW' in a brown, sans-serif font.

VISTA
SHAW



Why Choose **MANDALUYONG CITY?**

- Lies in the middle of the “Golden Triangle” of Makati, Manila and Quezon City and straddles Metro Manila’s economic beltway that is EDSA.
- Tiger City of Metro Manila
- Shopping Capital of the Philippines





VISTA SHAW

FAST FACTS

TOTAL NO. OF FLOORS	38
STUDIO	22.40 – 27.60 SQ.M.
1-BEDROOM	30.40 – 36.03 SQ.M.
2-BEDROOM	47.70 – 50.40 SQ.M.
UNITS PER FLOOR	20 – 23
AMENITIES	39 TH FLOOR



VISTA SHAW

PRIME LOCATION

515 Shaw Blvd.,
Corner Laurel St.
Mandaluyong City



PRIME LOCATION





STACKING DIAGRAM

Parking – 4 Basement Parking
Ground Floor - Commercial Area /
Grand Lobby

2nd – 20th Floor – Residential Low Zone

21ST – 38th Floor – Residential High Zone

39th Floor – Sky Amenities (Fitness
Gym, Adult Pool, Kiddie Pool, Pool Deck
Function Area, Game Room)

COMMERCIAL ESTABLISHMENTS



Residents will have access to more than 350 sqm commercial and retail stores in the commercial building in front of the towers.

LAUREL ST.

WACK WACK

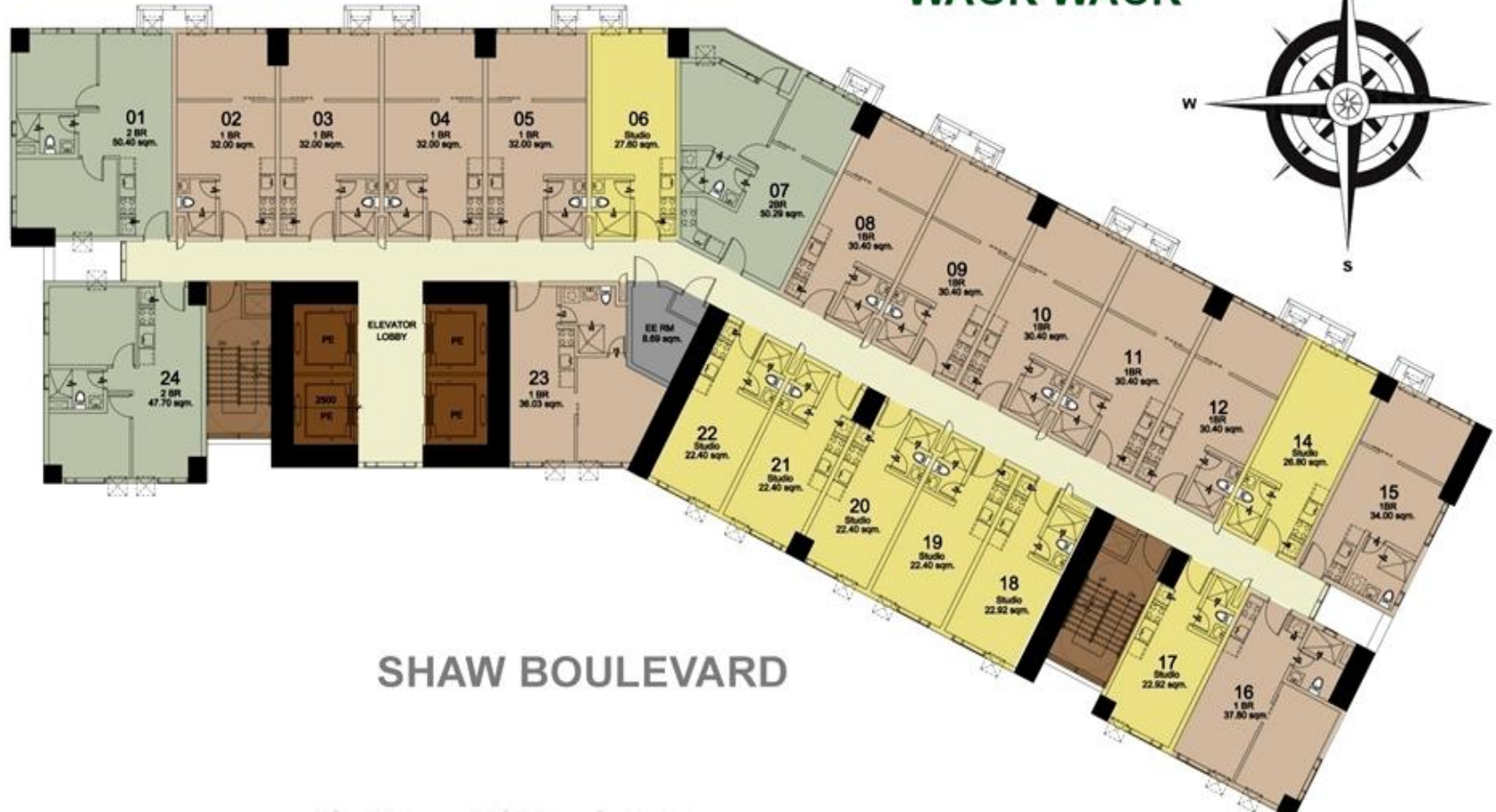
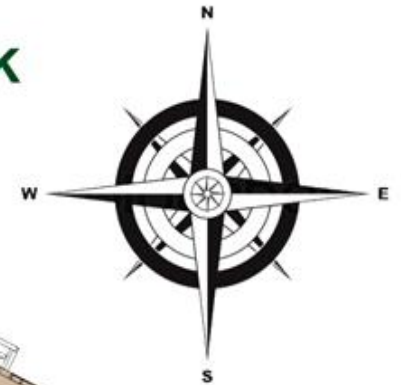

SHAW BOULEVARD

TYPICAL FLOOR LOW ZONE

WACK WACK

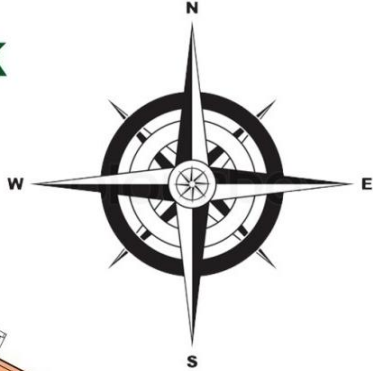

LAUREL ST.

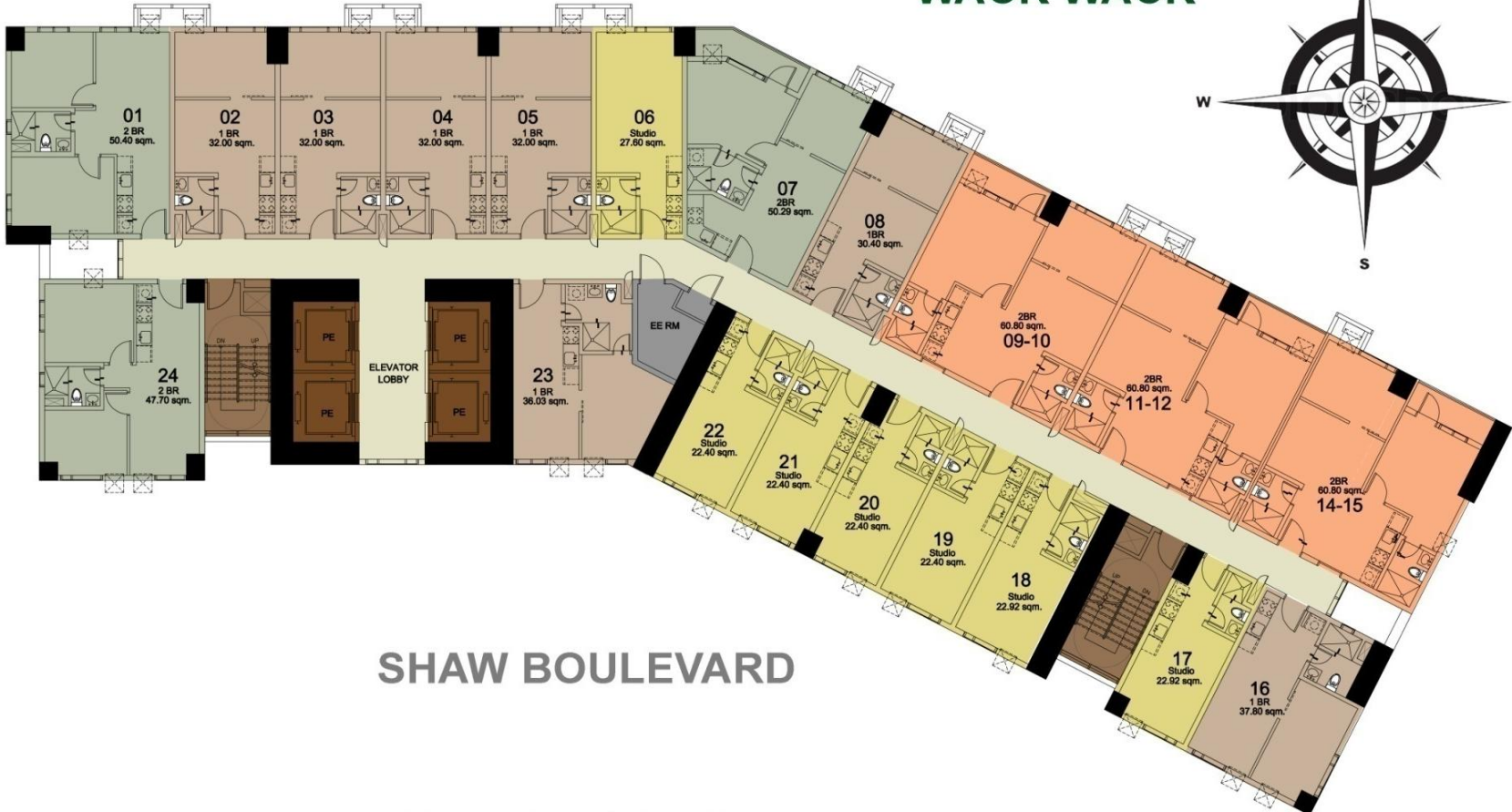

SHAW BOULEVARD

TYPICAL FLOOR HIGH ZONE



Studio Unit

◆ 22.40sqm | 22.92sqm
26.80sqm | 27.60sqm



One Bedroom Unit

◆ 30.40sqm | 32.00sqm | 36.03sqm | 37.80sqm



Typical 1BR Unit



Unit 16 (37.80sqm)



Unit 23 (36.03sqm)

UNIT LAYOUTS

Two Bedroom Unit

◆ 40.70sqm | 47.70sqm | 50.29sqm | 50.40sqm



Typical 2BR Unit



Unit 07 (50.29)

Tandem Unit

◆ 60.80sqm



UNIT LAYOUTS



SKY AMENITIES



SCENIC VIEW – MAKATI SKYLINE



SCENIC VIEW – ORTIGAS SKYLINE



SCENIC VIEW – WACK WACK GOLF

PRIME UNIT DELIVERABLES

- Kitchen
 - Granite countertop
 - Modular kitchen cabinets, prefabricated
 - With provision for range hood and washing machine
- Toilet & Bath
 - Semi-pedestal lavatory – cabinets not incl.
 - Wall – 1.80m ceramic tiles
 - With provision for heater
- Flooring
 - Bedrooms (if applicable) – high grade vinyl planks
 - Living, dining & kitchen – 60x60 inches ceramic tiles
 - Toilet & bath – ceramic tiles
- Doors
 - Main Door – HDF (High Density Fiber)
 - Master BR (if 2BR) – MDF (Medium Density Fiber)
 - Bedroom (1 BR) – Sliding wood flush door
- Windows
 - 0.90m standard height (approx. 3.00ft)
 - Pre-fabricated aluminum
 - 9.00mm standard thickness; swing type opening
- Ceiling
 - Kitchen & Toilet – 2.40m high, gypsum board
 - Living, Dining and Bedroom – 2.80m high

TOP-TIER BUILDING FEATURES

- Front Desk / Concierge
 - 24/7 Security Services
 - State of the Art Fire Detection & Suppression Systems
 - Individual Mail Boxes
 - Three (3) Passenger Elevators
 - One (1) Service Elevator
 - Annunciator Panel with Emergency Speakers in all floors
 - CCTV Cameras at the common areas
 - Provision for Telephone and CATV provision
- Wi-Fi Ready in common areas
 - Standby Power Generators for common areas and selected outlet in each unit
 - Central Garbage System
 - Elevated Water Tank and Underground Water Cistern
 - Meralco (multi-metering) and Manila Water
 - Building Administration Office

THE VISTA LEASING ADVANTAGE

- ❖ One-Stop-Shop
 - Ease in coordination with support teams i.e. production, interior design, leasing operations and property manager
- ❖ Building locations ideal for leasing operations
- ❖ Wide market and network reach



